

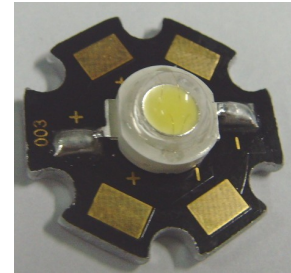

ATTENTION
OBSERVE PRECAUTIONS
FOR HANDLING
ELECTROSTATIC
DISCHARGE
SENSITIVE
DEVICES



Features

- Long operating life
- Highest flux
- Available in White: 2500K-25000K
- Lambertian radiation pattern
- More energy efficient than incandescent and most halogen lamps
- Low voltage DC operated
- Cool beam, safe to the touch
- Instant light (less than 100ns)
- Fully dimmable
- No UV
- Superior ESD protection
- RoHS compliant

Applications

- Reading lamps
- Portable lightings (flash lightings, bicycle)
- Indoor / Outdoor lighting
- Edge-lit signs (Exit, point of sale)
- Traffic signaling
- Architectural, landscaping and entertainment / advertising installations

Radiation Pattern

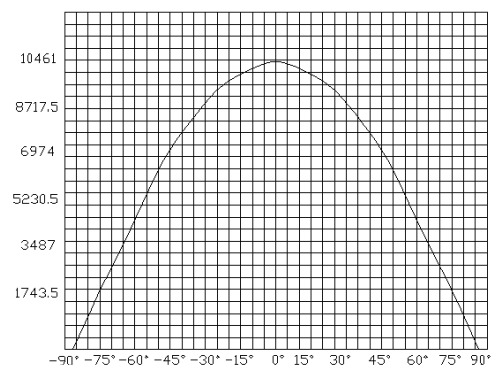
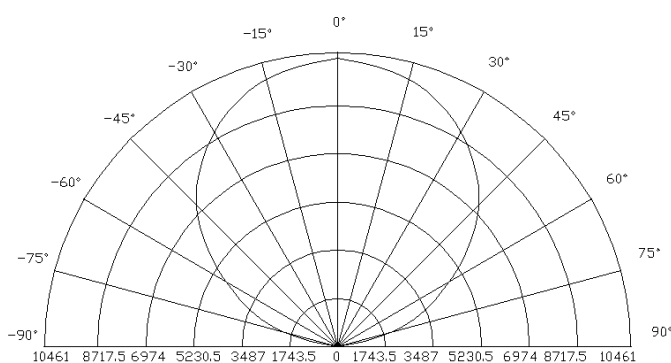

Typical Optical/ Electrical Characteristics @T_a=25°C

Item	Symbol	Condition	Min.	Typ.	Max.	Unit
Forward Voltage	V _F	I _F = 350mA	3.0	---	3.8	V
Reverse Current	I _R	V _R = 5V	---	---	30	μA
50% Power Angle	2θ _{1/2}	I _F = 350mA	120	---	140	deg
Luminous Flux	φ _V	I _F = 350mA	110	120	---	lm
Recommend Forward Current	I _F	---	---	350	700	mA
Chromaticity	T _C	I _F = 350mA	5665	---	6530	K
Thermal Resistance, Junction to Case	R _{JP}	I _F = 350mA	---	10	---	°C/W

Notes:

- Tolerance of measurement of forward voltage ±0.1V.
- Tolerance of measurement of peak wavelength ±2.0nm.
- Tolerance of measurement of luminous flux ±15%.

Absolute Maximum Rating

Item	Symbol	Absolute Maximum Rating	Unit
Forward Current	I _F	700	mA
Peak Forward Current*	I _{FP}	1000	mA
Reverse Voltage	V _R	5	V
Power Dissipation	P _D	3000	mW
Electrostatic discharge	E _{SD}	±2000	V
Operation Temperature	T _{OPR}	-40~+80	°C
Storage Temperature	T _{STG}	-40~+100	°C
Lead Soldering Temperature**	T _{SOL}	Max. 260°C for 3sec max.	

* I_{FP} conditions: Pulse Width ≤10msec duty ≤1/10

** All high power emitter LED products mounted on aluminum metal-core printed circuit board, can be lighted directly, but we do not recommend lighting the high power products for more than 5 seconds without an appropriate heat dissipation equipment.

Typical optical / Electrical characteristics curves ($T_a=25^\circ\text{C}$ unless otherwise noted)

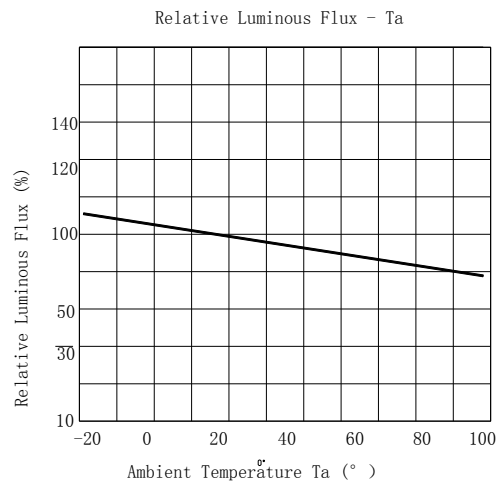
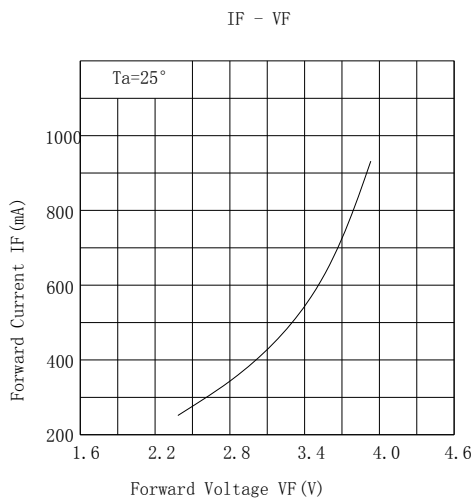
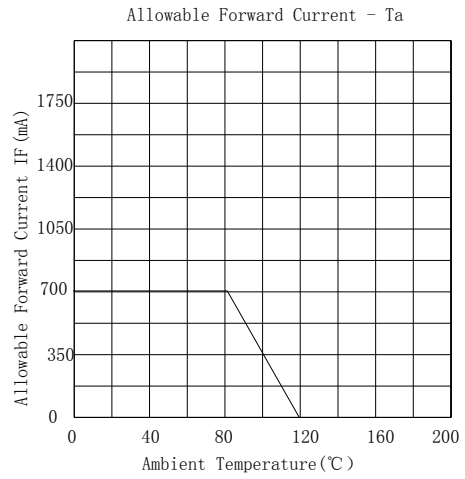
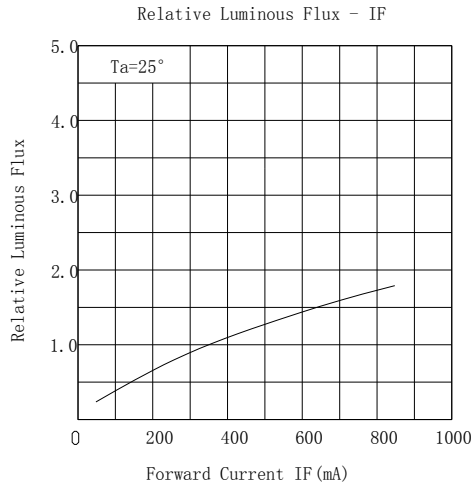

Wavelength Characteristics

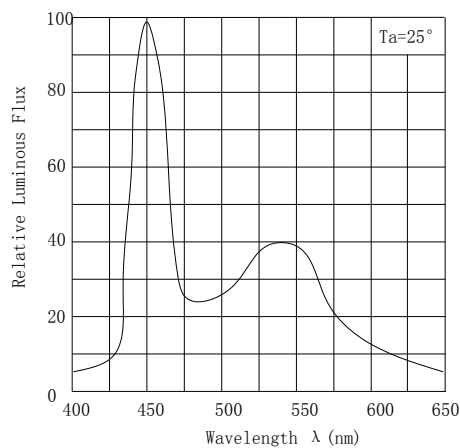

Package Dimensions

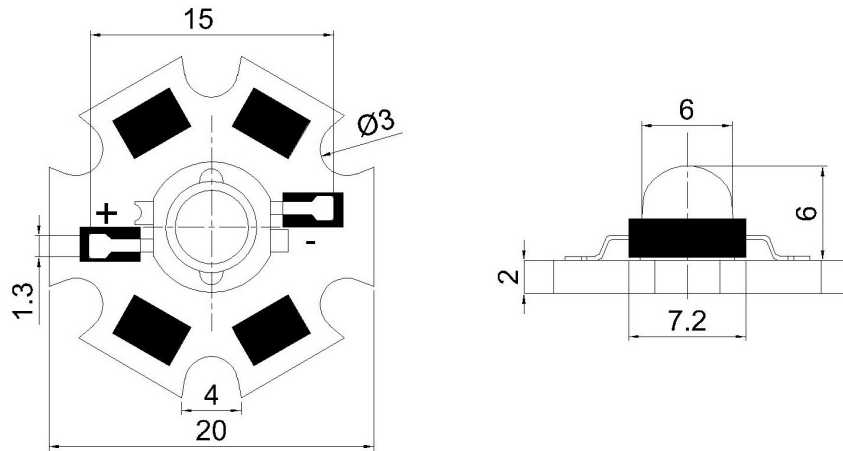

Notes:

- All dimension units are millimeters.
- All dimension tolerance is $\pm 0.2\text{mm}$ unless otherwise noted.

Tube Specifications (Units: mm)

