

IIH150xxx

Installation diameter	22mm
Type	With LED light
Rated voltage	6/12V/24V/110V/220V
Lighting color	R/G/Y/B/W/O
Body material	304 stainless steel
Polatry	No
Working temperature	-20°C~+55°C
Contact	Copper plated with silver
Plastic parts	PA66
Connection	screw terminal

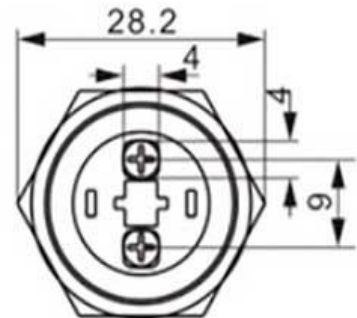

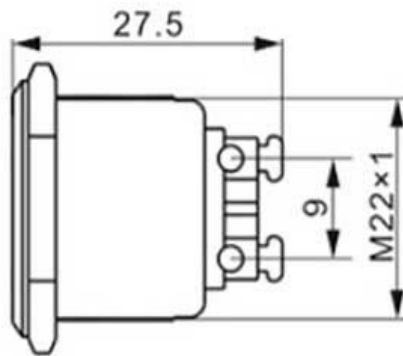
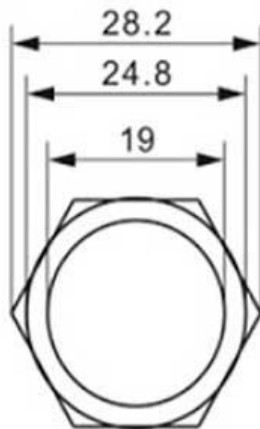

Main Technical Parameter



Lamp Type	LED lamp (AC/DC)
Rated Voltage (V)	6V, 12V, 24V, 110V, 220V
Rated Current (mA)	About 15mA
LED Colour	Red, Green, Yellow, Blue, White, Orange
Operating Temperature	-20 °C - +55 °C
Lamp Life	40000 hours (Reference)
IP Degree	IP65
Lamp Circuit Diagram	

Technical Specification



LED Voltage	Operation Voltage (Min. to Max.)	Operation Current (mA)
6VDC (without Resistor)	5.3 – 7.5V DC	20mA
12VDC	10.8 – 13.2V DC	20mA
24VDC	21.6 – 26.4V DC	20mA
110V AC	99 – 121V AC	6mA
220V AC	207 – 253V AC	3mA