

# BA11704

**12V5AH**

## PHYSICAL SPECIFICATION

Nominal Voltage		12V	
Nominal Capacity (20HR)		5Ah	
Dimension	Length	90	1mm (3.54 inches)
	Width	70	1mm (2.76 inches)
	Container Height	101	1mm (3.98 inches)
	Total Height	106	1mm (4.17 inches)
Weight		Approx. 1.55 Kg (3.42lbs)	
Standard Terminal		Fasten Tab No.250E	

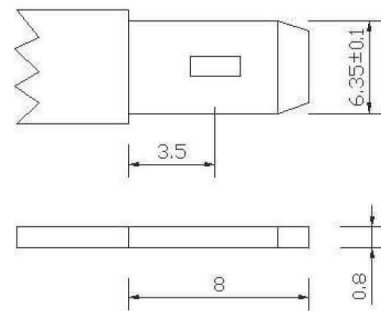
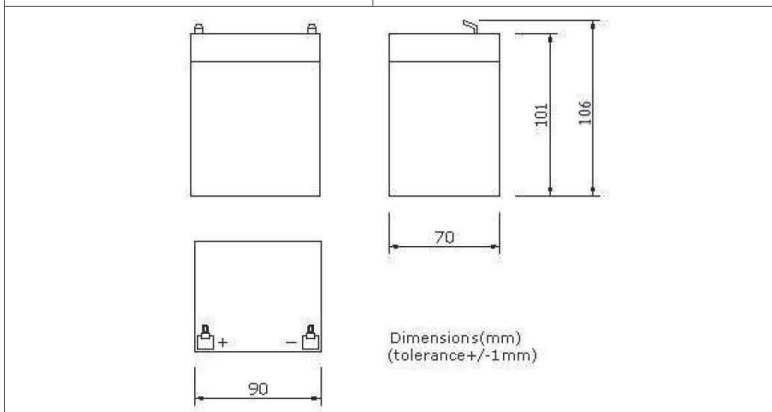

## ELECTRICAL SPECIFICATION

Characteristics	
Capacity	20 hour rate (0.25A) 5.5Ah
	10 hour rate (0.45A) 5.2Ah
	5 hour rate (0.85A) 4.6Ah
	3 hour rate (1.25A) 4.1Ah
	1hour rate (3.0A) 3.3Ah
Capacity affected by temperature	40°C (104 °F) 102%
	25°C (77 °F) 100%
	0°C (32 °F) 85%
Internal Resistance	Full charged battery (25°C, 77 °F) 30mΩ
Constant Voltage Charge	Cycle: Initial Charging Current less than 1.5A Voltage 14.4~15.0V at 25°C (77 °F) Temperature Coefficient -30mV/°C
	Standby: No limit on Initial Charging Current Voltage 13.5~13.8V at 25°C (77 °F) Temperature Coefficient -20mV/°C

### Discharge curves @ 25°C (77 °F)

