

START 1

Resistor - Weerstand - Résistance - Widerstand - Resistencia - Motstand - Vastus - Resistenze

- ◇ R1 : 1K (Brown, Black, Red) -(Bruin, Zwart, Rood) -(Brun, Noir, Rouge) -(Braun, Schwarz, Rot) -(Brun, Svart, Röd) -(Ruskea, Musta, Punainen) -(Marrón, Negro, Rojo) -(Castanho, Preto, Encarnado) -(Marrone, Nero, Rosso)
- ◇ R2 ... R7 : 10K (Brown, Black, Orange) -(Bruin, Zwart, Oranje) -(Brun, noir, Orange) -(Braun, Schwarz, Orange) -(Brun, Svart, Oranje) -(Ruskea, Musta, Oranssi) -(Marrón, Negro, Naranja) -(Castanho, Preto, Laranja) -(Marrone, Nero, Aranciato)



2

Zenerdiode

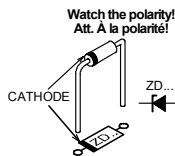

- ◇ ZD1 : 5V1

3

Diode

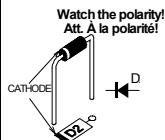

- ◇ D1 : 1N4007

4

Push button

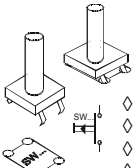

- ◇ SW1 : UP
- ◇ SW2 : SPACE
- ◇ SW3 : DOWN
- ◇ SW4 : ENTER

5

IC-socket

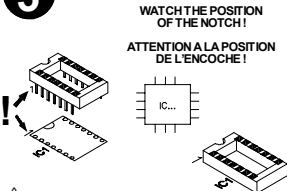

WATCH THE POSITION OF THE NOTCH!
ATTENTION A LA POSITION DE L'ENCOCHE!

- ◇ IC1 : 14p

MK18B1 manual

6

Capacitors



- ◇ C2 : 100nF (104)
- ◇ C3 : 100nF (104)
- ◇ C4 : 100nF (104)

7

Trimmer

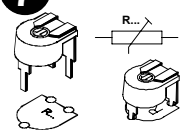

- ◇ RV1 : 1K

8

Resistor

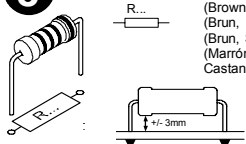

- ◇ R8 : 100E

(Brown, Black, Brown) -(Bruin, zwart, Brown) -(Brun, noir, Brun) -(Braun, Schwarz, Braun) -(Brun, Svart, Brun) -(Ruskea, Musta, Ruskea) -(Marrón, Negro, Marrón) -(Castanho, Preto, Castanho) -(Marrone, Nero, Marrone)

9

Transistor

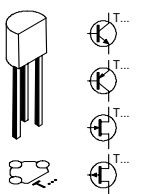

- ◇ T1 : BC547C

10

Voltage regulator

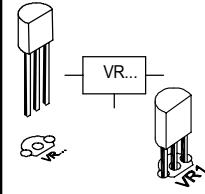

- ◇ VR1 : UA78L05

11

Electrolytic capacitor

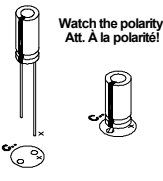

- ◇ C1 : 100µF / 16V

12

Screw connectors

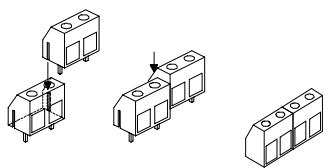

- ◇ SK1 : 2p -/+
- ◇ SK2 : 2p GND/RX

13

Jumpers

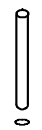

- ◇ SK3 : 6x
- ◇ SK4 : 6x

SOLDERSIDE

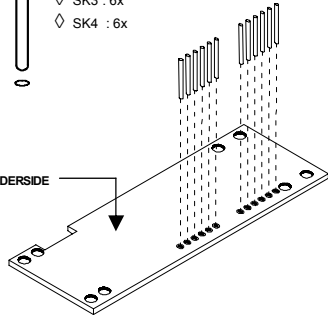

14

PCB assembly

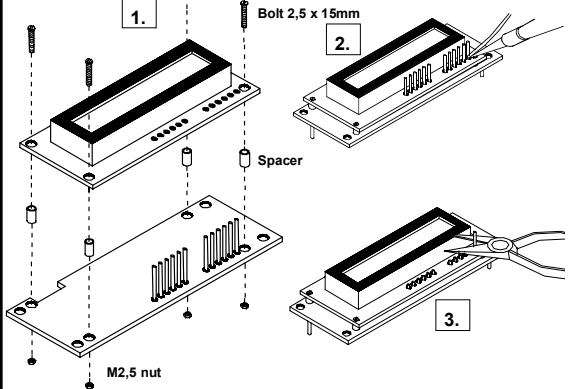

15

Final assembly

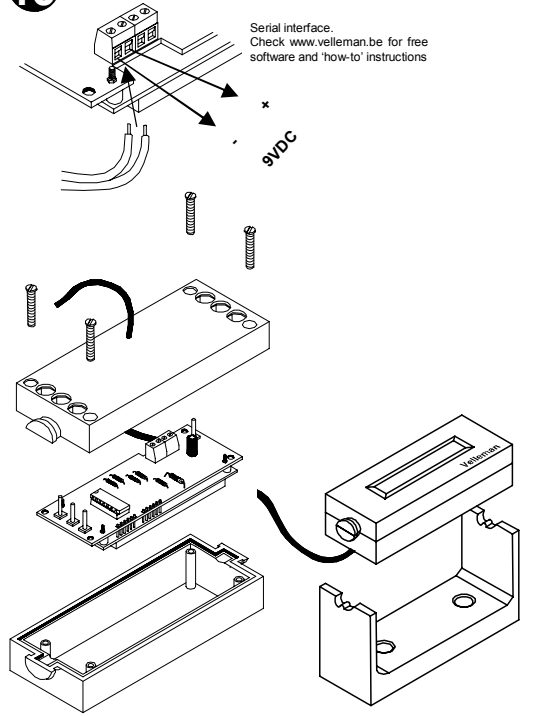

Serial interface. Check www.velleman.be for free software and 'how-to' instructions

9VDC

